



ENVIRONMENTAL CORPORATION OF AMERICA

April 15, 1998

Stephens County Development Authority
907 East Currahee Street
Toccoa, GA 30577

Attention: Mr. Lonnie Edenfield

Subject: **Phase II Environmental Site Assessment**
Hale Tract
Toccoa, Stephens County, Georgia
ECA Project Number: 8-521-2

Dear Mr. Edenfield:

Environmental Corporation of America (ECA) is pleased to provide this report of our work at the subject site. The work was performed in accordance with our Proposal Number 8-151-1 and your authorization to proceed on the project received March 26, 1998.

Background Information

ECA previously performed a Phase I Environmental Site Assessment at the Site. Based on this previous work, ECA discovered that wastes have been historically disposed on the site. More specifically, transformer casings, tires, furniture, drums, and other containers were located in one area of the site, near a former home site and an existing stream. Also, a former fuel service station is located near the southeast property corner of the subject site. A Phase II Environmental Site Assessment was requested to address these issues.

The purpose of the Phase II Environmental Site Assessment was to assess groundwater in down-gradient locations from the on-site dump area and to assess groundwater on-site in an area suspected of being down-gradient from the former fuel filling station, located southeast of the subject site.

Scope of Work

The scope of work to fulfill the purpose included the following items:

- ECA collected a surface water sample from an onsite location determined to be closest to the former fuel filling station. The sample was collected from the nearest possible on-site location where potentially petroleum-impacted surface water would enter onto the property, if present.
- ECA also collected one surface water sample from a point near the on-site dump area. Both sample locations are shown in Figure 1.
- All samples collected were placed in clean, new glassware vials and/or jars for transportation to the analytical laboratory. Care was taken to prevent any cross-contamination of the samples.
- The sample collected in the on-site location near the vicinity fuel filling station was analyzed for BTEX (benzene, toluene, ethylbenzene, and xylenes), which are common petroleum constituents, and PAHs (Polynuclear Aromatic Hydrocarbons).
- The sample collected from near the on-site dump area was analyzed for VOCs (Volatile Organic Compounds), TPH (Total Petroleum Hydrocarbons, and PCBs (Poly-Chlorinated Biphenyls).
- Chain of custody forms were completed and signed and accompanied the samples to the analytical laboratory.
- This report was prepared, which documents our work, reports our findings, and offers our conclusions and recommendations.

Field Work

ECA performed the sampling on March 31, 1998. Samples were collected in areas which were thought to have the greatest potential for environmental impairment, based on our previous work at the site, this Phase II Assessment, and the Preliminary Wetlands Delineation, which was performed in conjunction with this Assessment (ECA Project #: 8-521-3). Sample locations are shown in the attached Figure 1.

Surface water sample 1 (S1) and surface water sample 2 (S2) were collected from a spring downgradient from the on-site dump area and from surface water entering the site from the area down-gradient from the former fuel filling station, respectively. It was our opinion that groundwater discharges to the surface in the area of the springs. Therefore, samples of the

Mr. Lonnie Edenfield

Page 3

surface water emanating from the springs was considered the most likely representative sampling location.

The water samples were placed into laboratory prepared 40-milliliter vials and 1 liter amber bottles provided by the testing laboratory, labeled with the appropriate information, and immediately placed on ice in a cooler. The samples were then transported to Advanced Chemistry Labs in Atlanta, Georgia following standard chain-of-custody procedures.

The chain-of-custody and laboratory reports are attached in Attachment A.

Analytical Testing Results

Based upon the laboratory analytical results, the water samples collected contained no detectable levels of those constituents analyzed. This is an indication that the areas of the site subject to this Phase II Assessment have not been impacted by the past uses discovered during our work at the site. It is our opinion that the areas tested were on-site areas that would have likely been impacted by the sources identified during our work.

Closure

Environmental Corporation of America (ECA) appreciates the opportunity to provide Stephens County Development Authority with our environmental services. If you have any questions regarding this letter or the subject site, please call us at (770) 667-2040, extensions 1206 or 1228.

Sincerely,



Marvin G. Webster, Jr. REP
Project Scientist

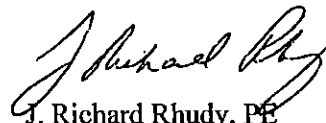

J. Richard Rhudy, PE
Principal Engineer

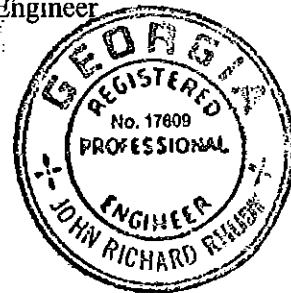

Figures

Figures

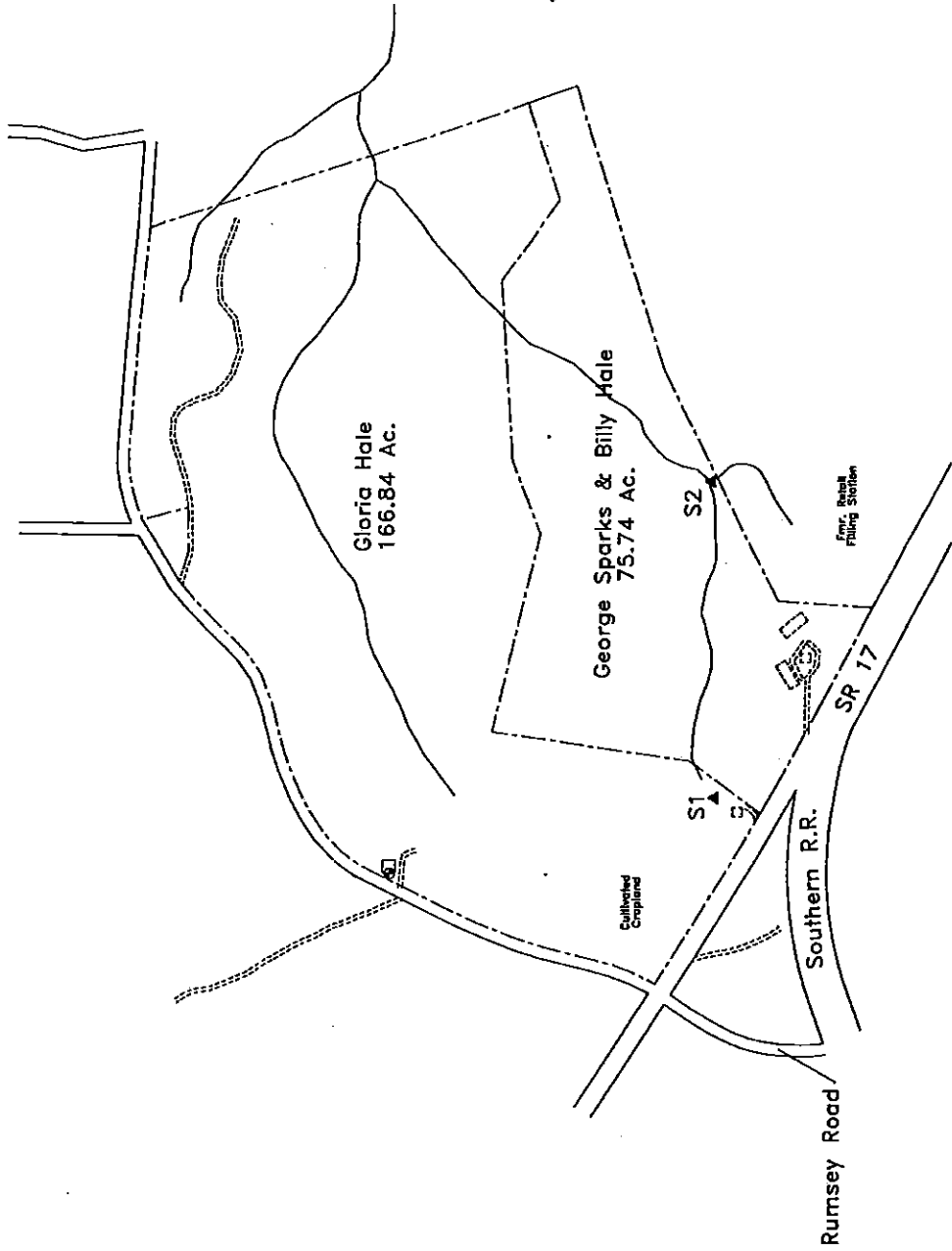

LEGEND	
---	PROPERTY LINE
→	PHOTOGRAPH ORIENTATION
○	WATER WELL
▲	SAMPLE LOCATION



ECA Project # B-521-2

Phase II Environmental Site Assessment
 Hale Tract, Stephens County, Georgia
 Figure 1: Sample Location Plan

SOURCE: Survey provided by client, ECA Field Notes, USGS Aerial Topographic Map, and Stephens County Tax Maps

DRAWN BY: MOW DATE: 4/14/98
 FILE NAMES: S:\5212pl.dwg

